

LCD SET UP

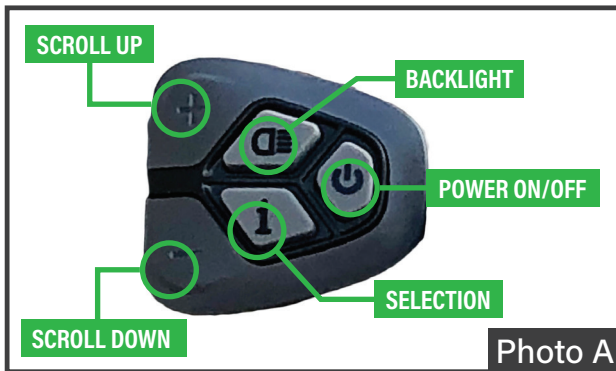

MENU – To access the **user settings menu**, hold the + and - buttons down for two seconds.

NAVIGATION – To **scroll up and down** the menu, use the + and - buttons. To scroll up, use the + and to scroll down, use the - button.

SELECTION – To make a **selection**, press the i button to confirm your selection.

UNIT – Use the + and - to select **Imperial US** or **Metric**. If you are in the U.S. then choose, Imperial US. Use the + and - to select the unit and then the i button to confirm the selection.

Press the - button for the next selection.

SPEED LIMIT – By default it's 20 mph. The top speed is determined by the battery voltage, motor type, and wheel size. If you know all those specs, then to change the speed, use the + and - to select the speed and then the i button to confirm the selection.

Press the - button for the next selection.

WHEEL SIZE – The default is 26". The choices are **16"**, **20"**, **24"**, **26"**, and **700c**. Use the + and - to select the wheel size and then the i button to confirm the selection.

Press the - button for the next selection.

MOTOR TYPE – E-BikeKit sells two types of motors. The **Heavy-Duty motor** is a 500w direct-drive, heavy-duty motor best for heavy riders and cargo. The **Performance motor** is 500w geared motor, best for top speed, and performance. Use the + and - to select the motor type and then the i button to confirm the selection.

Press the - button for the next selection.

BATTERY – There are 5 battery choices: **48v 9Ah**, **48v 10Ah**, **48v 14Ah**, **48v 20Ah**, **48v SLA**, **36v SLA** and **DIY**. DIY is a custom option that has 5 settings, (see the [video](#) at 16:05 for more information). The newer batteries will be the 36v and 48v li-ion batteries. Use the + and - to select the battery type and then the i button to confirm the selection.

Press the - button for the next selection.

CURRENT LIMIT – The E-BikeKit has a standard **20 Amp Controller**. This is the only selection, so no change is needed.

Press the - button for the next selection.

LCD DISPLAY SET UP VIDEO

Learn How To Set Up Your LCD Display

👉 [CLICK HERE!](#)

LCD SET UP

PAS SETTING – The E-BikeKit has three PAS settings. You can tinker and fine tune the PAS settings to make it custom for your liking.

- **PAS DELAY** – How many magnets pass the crank sensor before the PAS (motor) turns on. The default setting is 3.
- **PAS POWER** – Is how much torque is needed. The default is 5.
- **PAS SENSITIVITY** – Is a blanket power setting. The default is 12.

Use the **+** and **-** to select the PAS setting and then the **i** button to confirm the selection.

Press the - button for the next selection.

DRIVE – The E-BikeKit has three drive settings. The default is P/T Override.

- **P/T OVERRIDE** – Pedal Assist (P) is always on and Throttle (T) overrides. So if you are using pedal assist and then you use the throttle, the throttle will override the pedal assist.
- **THROTTLE ONLY** – Throttle will work but not pedal assist.
- **PAS ONLY** – PAS will work but not throttle.

Use the **+** and **-** to select the drive preference and then the **i** button to confirm the selection.

Press the - button for the next selection.

LCD LUMINANCE – The display will become brighter or darker with 100% being the brightest and 10% being the darkest. The default is 100%.

NOTE: E-BIKEKIT DOES NOT HAVE A HEADLIGHT. THE  REPRESENTS LUMINANCE ON THE DISPLAY. THIS SENSOR WILL SENSE, HOW MUCH OR LITTLE LIGHT IS PRESENT AND IT ADJUSTS THE DISPLAY. YOU HAVE THE OPTION TO INCREASE OR DECREASE THE BRIGHTNESS.

Use the **+** and **-** to select the luminance setting and then the **i** button to confirm the selection.

Press the - button for the next selection.

TRIP RESET – If you need to clear a trip. Use the **+** and **-** to select the yes or no and then the **i** button to confirm the selection.

Press the - button to go back to the main screen.

NOTES: _____

